

New Three Phase Energy Meter

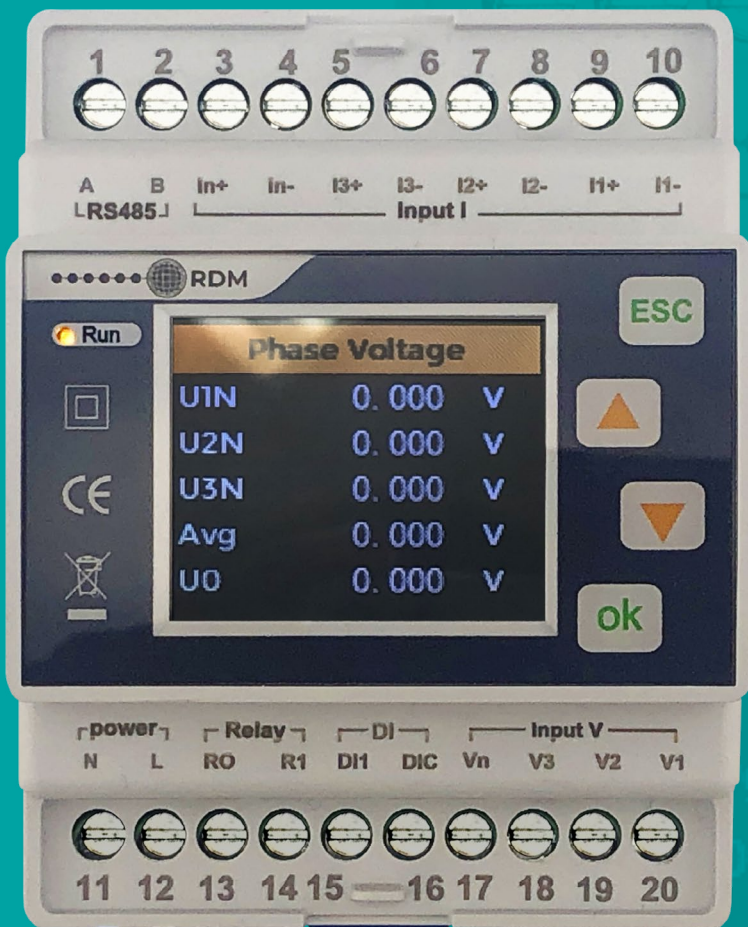

New Three Phase Energy Meter

Following the release of a new three phase energy meter, Resource Data Management (RDM) are now offering a device that delivers new benefits:

- A built-in colour display
- User-scaling of current transformer secondary input voltages
- Settable as single phase energy meter if required
- Real-time phasor diagram showing phase angles as a dial graphic
- Tariff menu allows selection of different tariff periods
- Internal real-time clock
- User-settable backlit timer and brightness
- Three built-in display languages: English, French, and Chinese
- User-settable keypad click tone
- Two password levels to restrict resetting of demand, tariff, energy levels, and factory default

The new three phase energy meter also features high accuracy levels for current (0.1%), voltage (0.2%), frequency (0.01%), and power factor (0.005%).

Replacing Previous RDM Three Phase Energy Meters

RDM's new three phase energy meter can replace older versions of RDM's three phase energy meters* where required. The previous two meters featured different CT secondary voltage, 0.333v and 0.1v, whereas the new meter can use either.

The new meter requires a different Modbus template to communicate with RDM's DMTouch or Intuitive TDB controller. When replacing a meter, it should be removed from either device and logged back on selecting the 'RDM Energy Meter (3 Phase)' template on the dropdown list to install the new energy meter.

The new template ships with DMTouch software version 4.3.1 and Intuitive TDB software version 4.6 as standard. If any software versions prior to these are installed on the devices, please contact RDM's Technical Support department (support@resourcedm.com) who will be able to supply the new template file free of charge. There is no need to update to the latest software version.

**Applies to product numbers PR0670-3PH-DIN and PR0690-3PH-DIN.*



Although the new three phase energy meter and previous meters are compatible and interchangeable, the terminals are in different positions. Please note the connection differences as shown below:

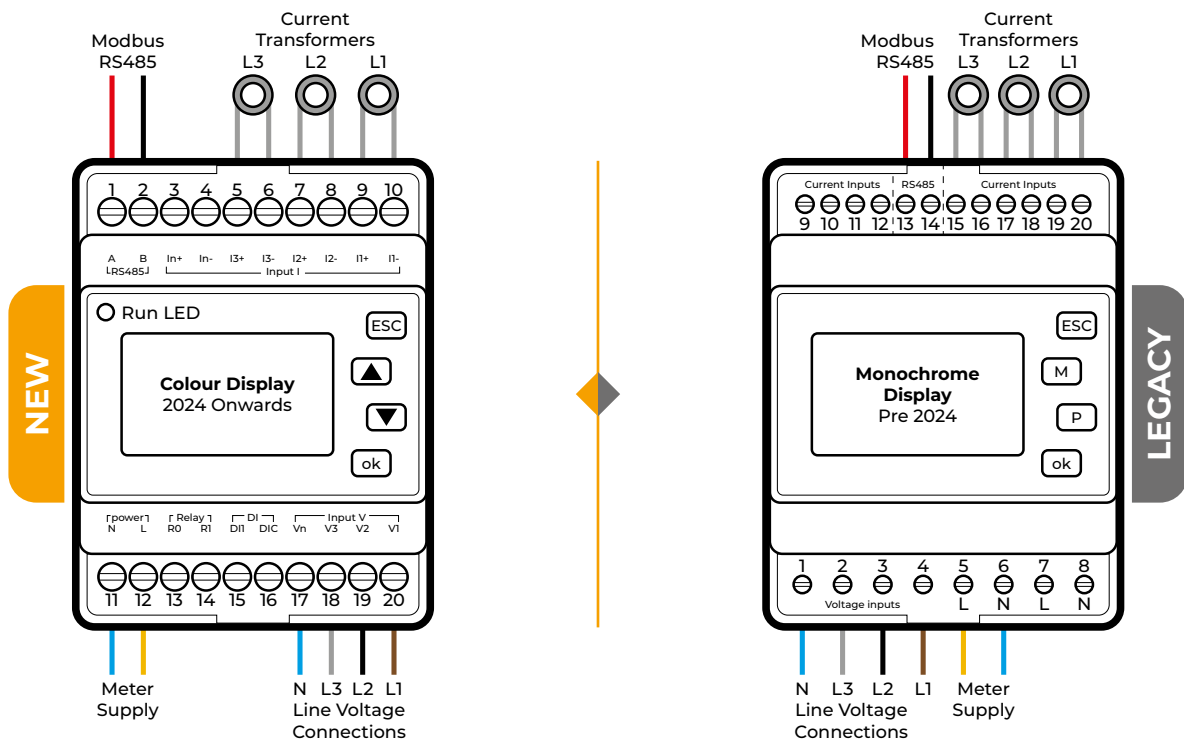

Ordering Information

The new meter, part number PR0672-3PH-DIN, replaces PR0670-3PH-DIN and PR0690-3PH-DIN.

DESCRIPTION	PART NO.
Three-Phase DIN Rail Mounted Energy Meter	PR0672-3PH-DIN
150A Split Core CT 0.333V output	PR0675-150A
400A Split Core CT 0.333V output	PR0675-400A
DIN Rail mounted IP to Modbus interface	PR0020 DUALDIN MOD
DIN Rail Mounted USB to Modbus Interface	PR0623 DIN
USB to Modbus Interface	PR0623